



## 400 Series- 31-406B-PSE caster



### Medium/ Heavy Duty

The Darcor Solid Elastomer wheel (SE) is the industry leader in applications demanding the lowest rolling resistance for heavier loads. It requires only 20 lbs. of force to move a one-ton (1000 kg) load and only 10 lbs. to keep it moving. The SE wheel provides excellent shock-absorption properties, wears like iron and is able to withstand harsh chemicals and extreme temperatures. The Broad temperature range encourages use in freezers where ordinary wheels will seize and become immovable.

### Features

Capacity	Up to 1000 lbs.
Leg Thickness	3/16
Mounting Plate Size	4" x 4-1/2"
Bolt Hole Spacing	2-5/8" x 3" slotted to 3" x 3-5/8"
Mounting Bolt Diameter	3/8

### Application

- |   |   |
|---|---|
| Food processing plant   | Seafood processing plants                 |
| Food service equipment  | Stock and maintenance carts               |
| Large volume, high temperature bakery and food cooking facilities | Ingredient bins                           |
| Bakery and bread racks  | Institutional service carts and equipment |
| Slaughter houses  | Hatcheries                                |
| Fisheries   | Pharmaceutical plants and laboratories    |



 Wheel Diameter	 Wheel Width	 Capacity lbs.	 Wheel Type
3"	2"	900	Solid Elastomer
4"	2"	900	Solid Elastomer
5"	2"	1000	Solid Elastomer
6"	2"	1000	Solid Elastomer
8"	2"	1000	Solid Elastomer

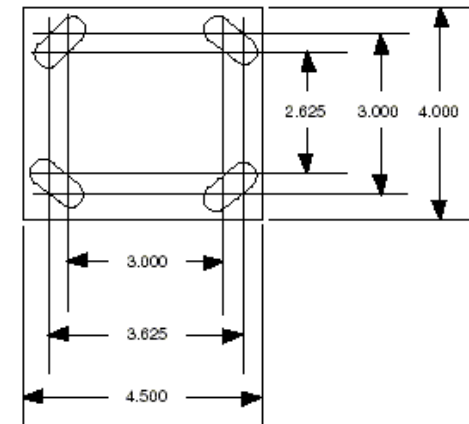

HOLES FOR 0.3125 BOLTS