



## Grey HU Solid Polyurethane Wheel- 15HU5228-S



### Heavy Duty

This stainless-steel caster provides you with a higher load capacity on commercial kitchen equipment. The HU solid polyurethane wheel is resistant to most solvents and can reject debris. This wheel can also withstand hard impact and abrasion. This wheel is perfect for the food industry as well as in warehouse environment.





### Features

Capacity	Up to 2100 lbs.
Leg Thickness	3/16
Mounting Plate Size	4" x 4-1/2"
Bolt Hole Spacing	2-5/8" x 3" slotted to 3" x 3-5/8"
Mounting Bolt Diameter	3/8

### Application

- |   |   |
|---|---|
| Food processing plant   | Seafood processing plants                 |
| Food service equipment  | Stock and maintenance carts               |
| Large volume, high temperature bakery and food cooking facilities | Manufacturing                             |
| Bakery and bread racks  | Institutional service carts and equipment |
| Slaughter houses  | Warehouse                                 |
| Fisheries   | Pharmaceutical plants and laboratories    |

-40°F to 160°F

 Wheel Diameter	 Wheel Width	 Capacity	 Wheel Type
5"	2"	1500	Solid HU Polyurethane
6"	2"	1800	Solid HU Polyurethane
8"	2"	2100	Solid HU Polyurethane

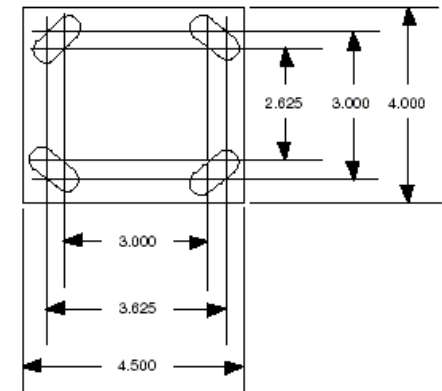

HOLES FOR 0.3125 BOLTS